

IFT245

IFK3006-BPKG/AM/P/US-104-DPS

Inductive sensors

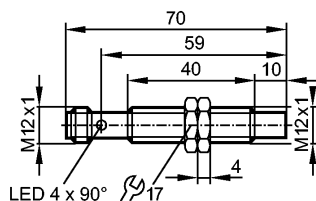

Made in Germany

Product characteristics

Inductive sensor	
Metal thread M12 x 1	
Quick disconnect	
Full metal housing	
Increased sensing range	
gold-plated contacts	
Sensing range 6 mm; [nf] non-flush mountable	

Electrical data

Electrical design	DC PNP
Operating voltage [V]	10...36 DC
Current consumption [mA]	< 25
Protection class	III
Reverse polarity protection	yes

Outputs

Output function	normally open
Voltage drop [V]	< 2.5
Leakage current [mA]	< 0.1
Current rating [mA]	100
Short-circuit protection	Yes (non-latching)
Overload protection	yes
Switching frequency [Hz]	500

Monitoring range

Sensing range [mm]	6
Real sensing range (Sr) [mm]	6 ± 10 %
Operating distance [mm]	0...4.9

Accuracy / deviations

Correction factors	mild steel = 1 / stainless steel = 1 / brass approx. 0.9 / aluminium approx. 0.75 / Cu approx. 0.6
Hysteresis [% of Sr]	1...20
Switch-point drift [% of Sr]	-10...10

Environment

Pressure rating [bar]	100; *)
Ambient temperature [°C]	0...100
Protection	IP 65 / IP 67 / IP 68 / IP 69K

Tests / approvals

EMC	EN 61000-4-2 ESD: 4 kV CD / 8 kV AD EN 61000-4-3 HF radiated: 10 V/m (80...2000 MHz)
-----	---

IFT245

IFK3006-BPKG/AM/P/US-104-DPS

Inductive sensors

		EN 61000-4-4 Burst: 2 kV EN 61000-4-6 HF conducted: 10 V (0.15...80 MHz) EN 55011 (Emission): class B
Impact resistance		DIN EN 60068-2-75 Ehc: 1 J
MTTF	[Years]	810

Mechanical data

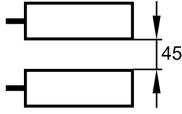
Mounting		non-flush mountable
Housing materials		housing: stainless steel 316L / 1.4404; active face: stainless steel 316L / 1.4404; lock nuts: stainless steel 316L / 1.4404; connector housing: PEI
Installation		
Weight	[kg]	0.032

Displays / operating elements

Output status indication	LED	yellow (4 x 90°)
--------------------------	-----	------------------

Electrical connection

Connection		M12 connector; gold-plated contacts
------------	--	-------------------------------------

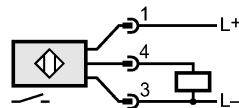
Wiring

Accessories

Accessories (included)		2 lock nuts
------------------------	--	-------------

Remarks

Remarks		*) sensing face
Pack quantity	[piece]	1